

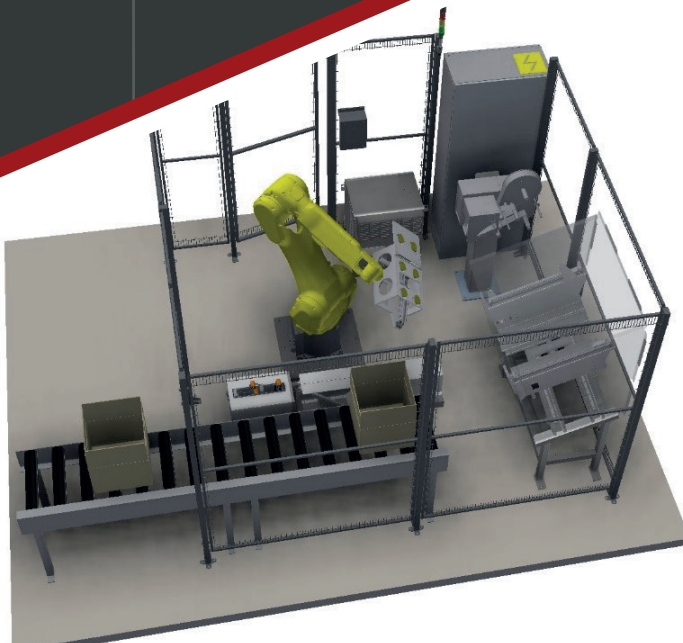

GiboSmartSolutions

GiboBox

Gibotech's box solution, GiboBox, is based on renowned technology and integrated into several different solutions over a number of years. The module can be purchased as stand-alone or as an integrated part of a box flow. Large cover area in box sizes and minimized footprint for optimal ROI.



ADVANTAGES

- Well-known technology tailored to your production
- Large box size coverage area
- Flexible and compact solution that can be extended in steps
- Higher throughput for increased productivity
- Reduction of one-sided, repetitive work
- Greater job satisfaction for increased productivity
- Releases employees for other tasks
- Improved competitiveness and greater employee satisfaction



Robot

Fanuc, KUKA, Omron TM



Workspace

Handles boxes from 120x120x120mm to 650x650x550mm



Modular

Can be joined with different packaging solutions and palletizing unit



Dimensions

2,5x2,5 m



Solution

Supplied as turnkey set up and ready to use



GIBOTECH^{AS}
GiboSmartSolutions

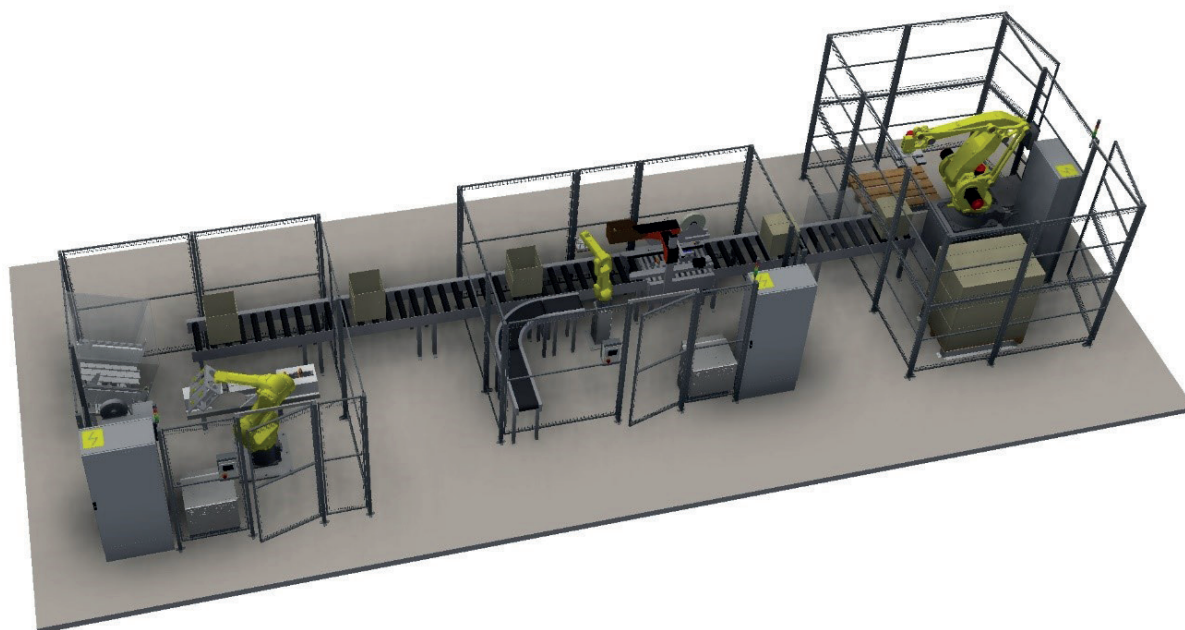

INCLUDED

- Fanuc M-20iD/25 incl teach pendant and controller
- Specially designed gripper for box erecting
- Manually adjustable cardboard magazine
- Label printer
- Erector guides
- Tape box bottom shutter
- 2 meter outlet box roll
- 1 customized HMI touchpanel with associated user interface
- Full safety solution with fences and doors
- Electrical cabinet and electrical components including:
 - o Photocells
 - o Cable trays
 - o Cables
- Complete documentation package incl. CE
- Options:
 - o Automatically adjustable cardboard magazine
 - o Box shutter with glue
 - o Laser printer
 - o Larger boxes can be handled by purchase of larger cardboard magazine and larger grippers

FUNCTIONALITY

GiboBox is a box erector based on a modular principle that allows you to expand with multiple modules if needed. If purchased as a stand-alone cell, GiboBox replaces the manual erection of cardboard boxes within dimensions 120x120x120mm to 650x650x550 mm. The cell is simple, user-friendly and with high output.

The operator selects the box size on the touchscreen, loads planosheet in the magazine and labels on the printer so that the cell is ready for operation. The robot grabs the planosheet, opens the box, applies a label and closes the box at the bottom. Then the box exits the cell with the top open and ready to be filled.

GiboBox can be expanded to operate multiple packing cells at a time by incorporating multiple outlets and cardboard magazines.

Gibobox is designed in solid material and well thought-out solutions to ensure maximum operation with minimal maintenance costs if the facility is inspected by authorized Gibotech service personnel at least once a year.

GiboBox is part of GiboSmartSolutions and in close relation to GiboPack and GiboPalletize.